

MATRIX



powered by Pro Mach 

Matrix Packaging Machinery, a division of PRO MACH, is the leading manufacturer of vertical form-fill-seal machines in North America. Founded in 1988, Matrix has a reputation for building rugged, easy to use and maintain machines. The lowest cost of ownership combined with experienced sales, application, and service support allow for the most profitable machines in the industry. Matrix has established long term customers throughout the world, packaging a wide variety of products in very diverse conditions.

CONTACT information:

650 Dekora Woods Boulevard
Saukville, WI 53080
Toll free 888-Matrix1
Main Office 262-268-8300
info@matrixpm.com
sales@matrixpm.com
www.matrixpm.com

MADE IN THE USA



MERCURY HS VERTICAL FORM-FILL-SEAL

"The Mercury HS is simply the most profitable machine in the world for Matrix customers"

STANDARD NO EXTRA COST FEATURES:

- Automatic film tracking
- Stainless steel frame
- Registered film sensor
- Print registration roller
- Unwind film spindle
- 14" maximum roll diameter
- Stainless steel NEMA 4X electrical enclosure
- Allen Bradley MicroLogix PLC
- 7" color touch screen
- Danaher MicroStepping Motors for film pull and jaw motion control
- Stainless steel adjustable mounting feet.

MATRIX

MERCURY HS

VERTICAL FORM-FILL-SEAL

Power requirement: 208-240VAC 30AMP
Single Phase 50/60Hz

Air requirement: 3-10 CFM @ 80 PSI
(demand varies by application)

Bag size: 1.75" to 11" (44mm to 279mm) Wide
2.5" to 15" (60mm to 390mm) Long

Cycle speed up to 140 BPM

Highest performance for the price

Laminate or poly film sealing capability

Full compatibility with all types of fillers

MANY available options including:

- Hole punch (mechanical or heated)
- Tear notch
- Flat bottom and gusset/tucker attachment
- Gas flushing system for M.A.P. applications
- Wash down
- Load shelf for heavier bags (several types)
- Printer, labeler, valve applicators
- UL electrical system, CE certificates

FRONT VIEW

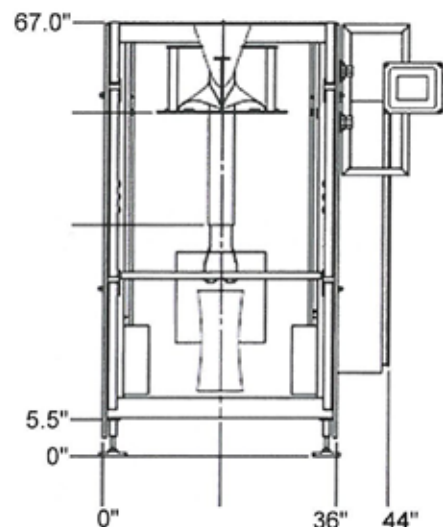

SIDE VIEW

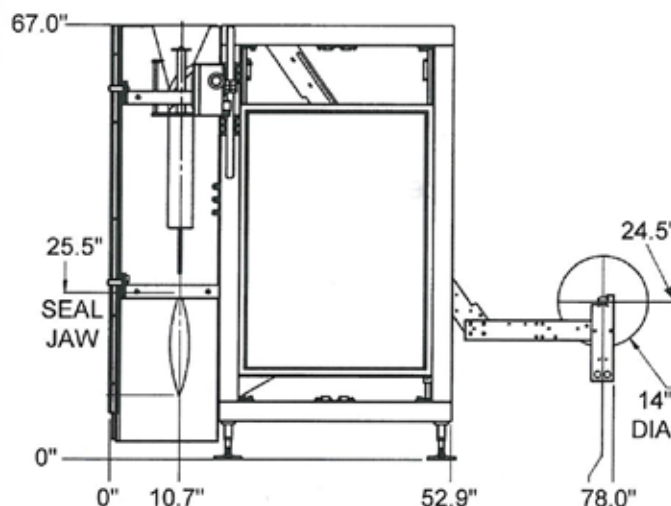

TOP VIEW

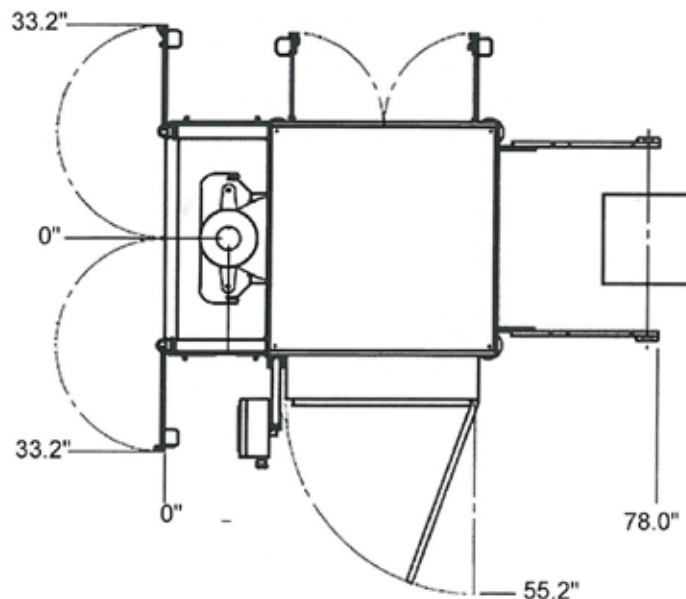

TYPICAL SYSTEM HEIGHTS

183"
to top of

Combination Scale with in-line metal detector

120"
to top of

Auger with typical tooling and top plate

127"
to top of

Cup Filler Product Hopper (infeed location)